

# 2997 Princeton Pike

Lawrenceville, NJ 08648

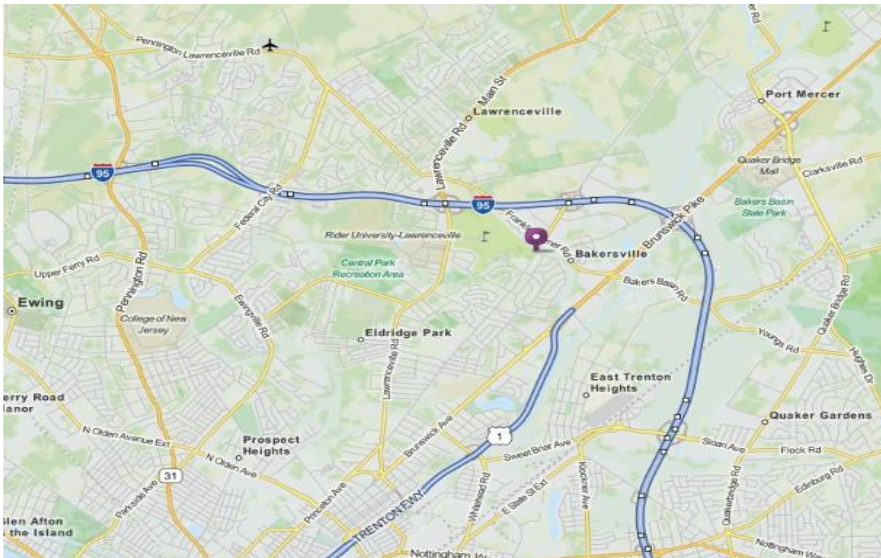

**Medical or Office Space**



**Lease:**

**Immediately Available  
4,975 SF**

- Lease: \$22.00 SF plus utilities and janitorial
- Total Building: 15,200 SF
- Parking: 58 covered spaces
- Law-Firm Build-out available
- Restrooms with showers
- Public Transportation (Bus) in-front of property
- Located on Princeton Pike, close to Franklin Corner Rd. and Entrance/Exit Ramp I-95/ I-295; easy Access to US Rt. 1, I-295, I-95, and Rt. 206

**Contacts: Jerry Fennelly**

[www.Fennelly.com](http://www.Fennelly.com) | **609.520.0061** | [Fennelly@Fennelly.com](mailto:Fennelly@Fennelly.com)

**NAIFennelly**  
Commercial Real Estate Services, Worldwide.

# 2997 Princeton Pike

Lawrenceville, NJ



## Medical or Office Space

- 2997 Princeton Pike is an industrial property.
- 15,200 SF modern office building.
- Tenant controlled Heat & AC. Elevator Serviced.
- Convenient Parking at front door, Handicap Accessible.
- Well maintained.
- Campus like Setting.
- Property is built on an average sized lot among other industrial properties in Lawrenceville's Professional/Medical District (close to downtown Princeton)

**Contacts: Jerry Fennelly**

www.Fennelly.com | **609.520.0061** | Fennelly@Fennelly.com

**NAIFennelly**

Commercial Real Estate Services, Worldwide.

# 2997 Princeton Pike

Lawrenceville, NJ 08648

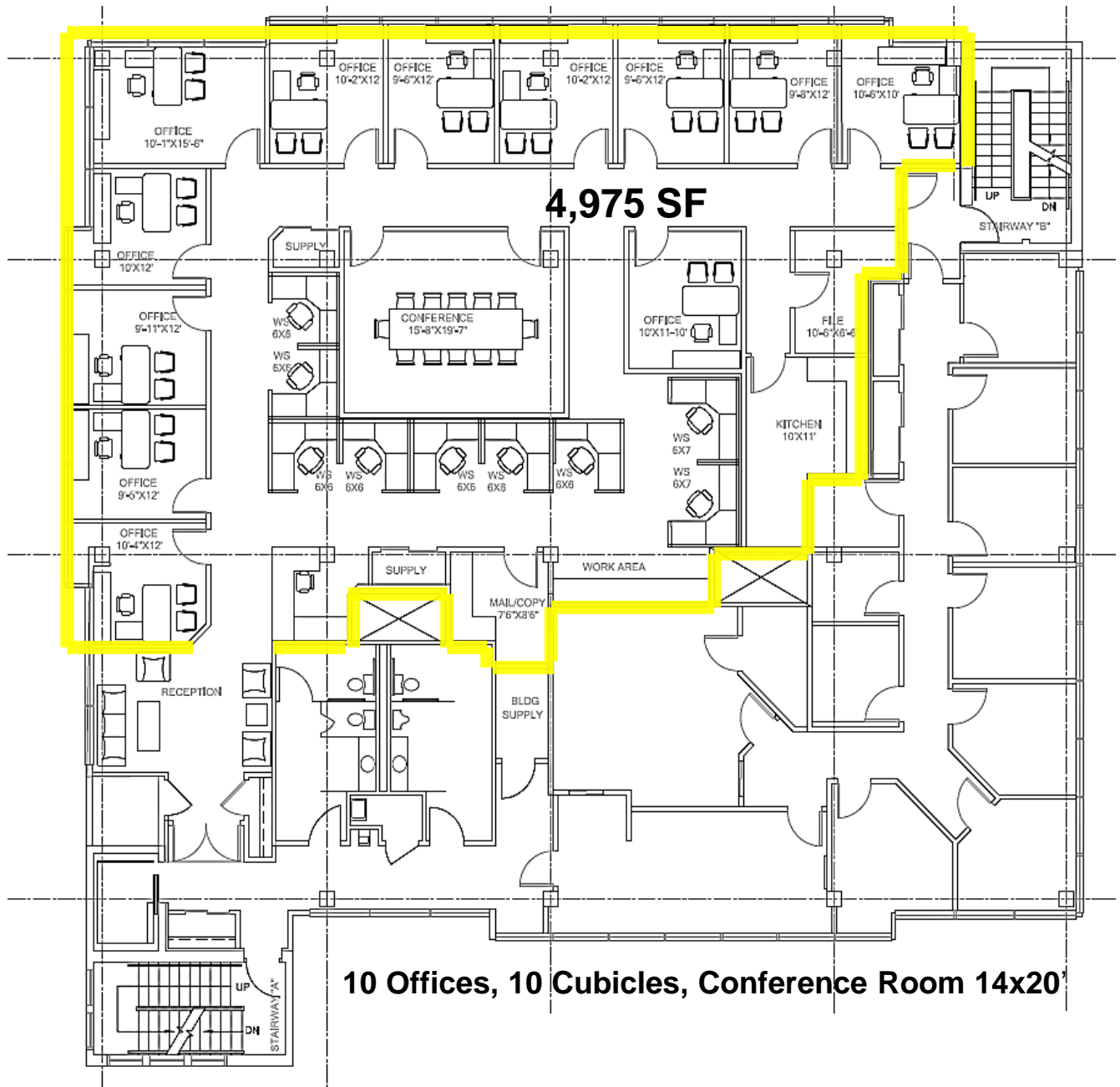

## Floorplan: Top Floor Unit 4,975 SF

**Contacts: Jerry Fennelly**

[www.Fennelly.com](http://www.Fennelly.com) | **609.520.0061** | [Fennelly@Fennelly.com](mailto:Fennelly@Fennelly.com)

**NAIFennelly**  
Commercial Real Estate Services, Worldwide.